

Pistons and Rods

Compressor Pistons and Rods

ACI engineered OEM equivalent components are available for all piston and rod assemblies. Using modern design techniques, ACI provides these improved alternatives:

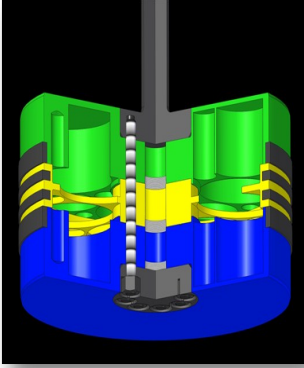

Segmental Piston and Flanged Piston Rod

- Piston segments and seal elements are removable without disturbing the piston rod to crosshead attachment
- Existing piston rods may be reused for cost savings
- More accurate torques of lesser values is achieved by using multiple studs to attach the piston segments to the piston body and/or the piston to the rod
- Piston end mechanical clearances need not be disturbed
- Robust, radial thickness rider rings provide greater stability
- Riders can be indexed to new bearing arc surface running position

Multi-Piece Piston and Flanged Piston Rod

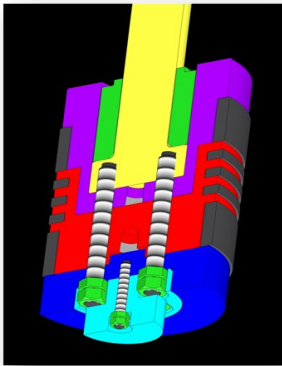

- Complete piston is removable from cylinder without disturbing rod to crosshead attachment
- More accurate torque of lesser values is achieved by using multiple studs to attach the piston to the piston rod flange
- Piston mechanical end clearances need not be disturbed
- Robust, radial thickness rider rings provide greater stability
- Rider Rings easily installed in the open-ended grooves
- Riders can be indexed to a new bearing arc surface running position
- Cost effective replacement of individual piston components

Multi-Piece Piston and Thru-Bolt Rod

with Exacto Torque™ Piston Nut

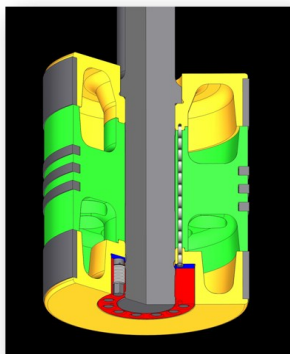

- Can offer the same rider ring features as flanged multi-stud piston attachment
- Piston serviceability is easier than with a one-piece piston design
- The ExactoTorque Piston Nut allows more accurate torque achievement, with readily available torque devices, by distributing the load over multiple fasteners.

Reciprocating Compressor Experts

125 Steubenville Ave. • Cambridge, Ohio 43725

Phone: (740) 435-0240 • Fax: (740) 435-0260

Visit our websites: www.ACIServicesInc.com

www.CompressorConnection.com